

Timber Appraisal Report



Permit Holder Clement Logging	Sale Type Intermediate Auction	RAN 253	Permit Number X013380
Permit Date 06/19/2012		Expiration Date 05/31/2015	

	The resource management of the Minnesota DNR's state forests and wildlife management areas meets the objectives of the SFI ® program (Certificate No. 6Y921-S1) and the principles of the FSC ® certification standard (Certificate No. SCS-FM/COC-00088N).	FSC 100%
--	---	---------------------

Appraisal includes one (1) cutting block:

Block #	Legal Description	Sec-Twp-Rng	County
1	NENW,NWNW	4-59-4W	16: Cook

Species/Products/Price (All quantities are estimates):

Bid	SOAV	Species	Product	Quantity	UOM	Appraised Price	Appraised Value	Bid %	Bid Price	Bid Value
+		Paper Birch	Woodsrun Cordwood	375.00	Cd	7.23	2,711.25	0	7.23	2,711.25
		Maple Species	Woodsrun Cordwood	75.00	Cd	7.23	542.25		7.23	542.25
		Aspen Species	Woodsrun Cordwood	50.00	Cd	15.90	795.00		15.90	795.00
		White Spruce	Woodsrun Mixed Products	25.00	Cd	21.24	531.00		21.24	531.00
		Any Listed Species	Offered Optional Biomass	275.00	Tons	1.00	0.00		1.00	0.00

Sale Acres	66.0	Advance Payment	686.93	Total Appraised Value	4,579.50	Total Bid Value	4,579.50
------------	------	-----------------	--------	-----------------------	----------	-----------------	----------

Top Diameter Utilization: Unless otherwise specified, each species product must be utilized down to a minimum merchantable top diameter inside bark (dib) as follows: 3 inches for woodsrun cordwood, 10 inches for sawtimber, and 14 inches for veneer.

Total Appraised Cords per Acre: 8.0

Mixed Species Description:

Aspen Species Woodsrun Cordwood includes: Balm of Gilead 20%; Trembling Aspen 80%.
 Maple Species Woodsrun Cordwood includes: Red Maple 10%; Sugar Maple 90%.

Mixed Product Description:

White Spruce Woodsrun Mixed Products includes: Bolts 60%; Pulpwood 40%.

HARVEST SPECIFICATIONS

Cutting and Felling:

- Harvest all paper birch, aspen, spruce, and tree marked with orange paint.
- Reserve all non-hazardous snags.

Season of Operations:

- Conduct sale operations on dry or frozen soil conditions only, except with written permission from State.
- Operate during non-rutting soil conditions. Refer to DNR rutting guidelines.

Slash Disposal:

- Lop and scatter slash evenly over the harvest site to within 2 feet of the ground.
- Biomass harvest is allowed on this permit. An Added Timber Agreement is required.

Timber Appraisal Report - Harvest Specifications (Continued)

HARVEST SPECIFICATIONS

Slash Disposal (Continued):

- If biomass is purchased with an Added Timber Agreement, 20% of the tops and limbs must be left on the site or hauled back from the landing and redistributed in the general harvest area. This percentage may be adjusted up or down to meet the 1/3 retention goal if incidental breakage is more or less than 10-15%.

Site, Soil and Water Protection:

- If site damage becomes apparent, alter or cease operations and contact State.
- Leave at least 5 sound downed logs greater than 6" diameter and 6 feet in length per acre.
- Wetlands requiring filter strips occur on this permit.

Landings Roads and Trails:

- The location and construction of all roads and landings must be pre-approved by the State.
- Haul roads will be restored to pre-sale conditions.
- Block Haul road and skid trails as directed by the State when leaving the site for more than two weeks and / or upon completion of operations.

Sale Conditions:

- Access is across state land.

Marketing and Special Conditions:

This sale has a dry/late summer and dry fall harvest opportunity for harvest. Price reduced 15% for timber quality and access.

Averages:

maple 3.5 sticks, 8-12" dbh

birch 3.5 sticks, 10-14" dbh, 10% bolts

aspen 4 sticks, 10-14" dbh

spruce 4.5 sticks, 8-14" dbh, 60% bolts

Appraiser = Bushmaker

Permits Required:

(None)

Forestry Area Office:

Two Harbors Area Forestry Office

1568 Highway 2

Two Harbors, MN 55616

Telephone: 218-834-1420

Appraiser Signature	Appraiser (Printed name) Jason A. Bushmaker	Appraiser ID # 01118506	Signature Date 05/03/2012
Approved By Signature	Approved By (Printed name) Jeffrey C. Busse	Approver ID # 01099175	Approval Date 05/07/2012



Permit Holder Clement Logging	Sale Type Intermediate Auction	RAN 253	Permit Number X013380
	Permit Date 06/19/2012	Expiration Date 05/31/2015	

GPS Location: Latitude - 47 37 44, Longitude - 90 51 1

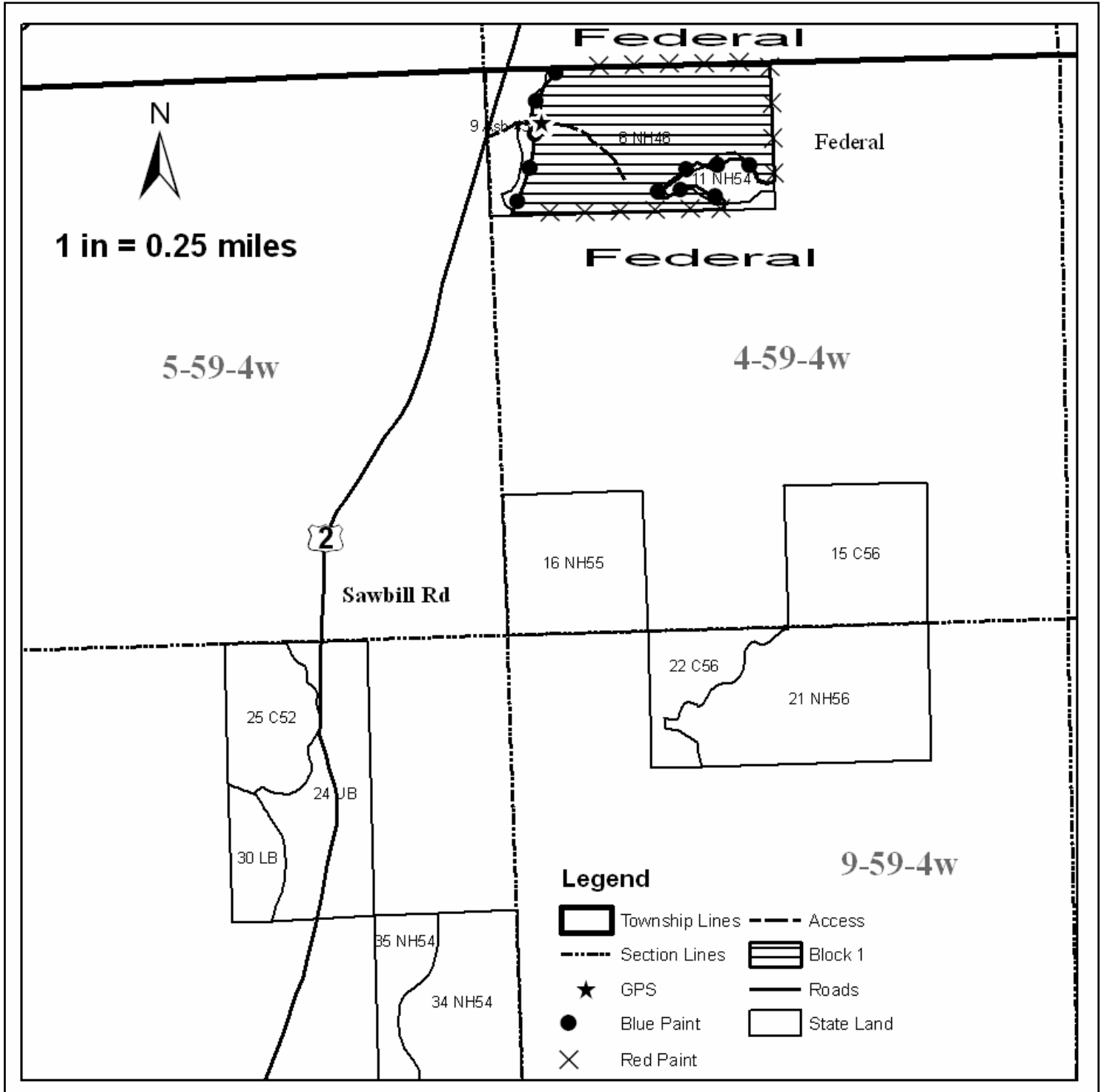

(Cutting Block ID 9721, Snapshot Nbr 0)

Cutting Block Map (may not print to scale)

SOAV Eligible: No

Stand Management Information - Appraisal includes one (1) cutting block:

Site t05904w1040006	Harvest Prescription Regen Harvest-Uneven-Aged-Uneven Age Group Sel w/Rsrv						
Stand	Cover Type	Plan Status	Planned	Examined	Appraised	Deferred	Altered
t05904w1040006	NH	Adopted	45.0	45.0	45.0	0.0	0.0
t05904w1040011	NH	Adopted	15.0	15.0	15.0	0.0	0.0
t05904w1040010	NH	New	6.0	6.0	6.0	0.0	0.0
Totals			66.0	66.0	66.0	0.0	0.0

Forty/Lot Information - Appraisal includes one (1) cutting block:

Twp - Range	Sec	Forty / Lot	Land Status	Acres	% Total Value
59-4W	4	NENW	09: School	33.0	50
		NWNW	09: School	33.0	50
Totals				66.0	100

Specifications included in Notice Of Sale:

Cutting and Felling:

- Harvest all paper birch, aspen, spruce, and tree marked with orange paint.

Season of Operations:

- Conduct sale operations on dry or frozen soil conditions only, except with written permission from State.
- Operate during non-rutting soil conditions. Refer to DNR rutting guidelines.

Slash Disposal:

- Lop and scatter slash evenly over the harvest site to within 2 feet of the ground.

Site, Soil and Water Protection:

- If site damage becomes apparent, alter or cease operations and contact State.

Landings Roads and Trails:

- The location and construction of all roads and landings must be pre-approved by the State.

Sale Conditions:

- Access is across state land.